

Advantages

- Excellent insulation characteristics.
- No loss of thickness even under high static or dynamic loads.
- Maximum load bearing capacity 3 tonnes/m² (30kN/m²).
- Minimises construction height.
- Resistant to ageing and deformation.
- Permanently elastic, no degradation over time.
- Excellent recovery properties.
- Quick and easy to install.
- Can be fully recycled.

Applications

Wilhams WIL-MAT RSD-T&G is applied under the entire laminate area in dwellings, commercial and industrial buildings e.g. on intermediate floors as an insulating layer under the laminate in storerooms, industrial units, hotels, hospitals, libraries, schools, universities and general offices.

Description

Wilhams WIL-MAT RSD-T&G is resin bonded rubber sheeting laminating to water chipboard.

Physical Information

Sheet size: 2400mm x 600mm

Material thickness: 24mm

Technical Information

Wilhams WIL-MAT RSD-T&G conforms to the following specifications:

Total Laminate Weight 15.38kg/m²

T&G 18mm

➤ 12.5kg/m²

WIL-MAT 60

- Colour – Black / Anthracite
- Density 600kg/m³
- Maximum load bearing – up to 3,000 kg/m²
- Deflection of less than 1mm under load 0.14MPa and dynamic stiffness of 0.25MPa at 0.9 N/mm³.
- Tested according to BS EN 29052-1:1992, compliant with Approved Document E.
- Temperature range – -30 to +80°C



Acoustic Performance

Test Product	Floor Type	Impact db (L'nT,w)	Impact db (Ln,w)	Airborne db (C; ctr)
Bare Construction	15mm Screed / 150mm Concrete Beam	71	76	53 (-1 ; -4)
Wil-Mat 60	Concrete Floor / Wil-Mat 60 + 18mm T&G	54	59	53 (-3 ; -7)

Tested to Robust Standard report no. 3918 & 3919

Installation Guidelines

Before installing the Wilhams WIL-MAT RSD-T&G, ensure the concrete floor is dry, clean and free of dust. Minor variations of 1-2mm in the concrete surfacing will not be detrimental to the performance of the WIL-MAT RSD-T&G.

Lay out the WIL-MAT RSD-T&G ensuring all edges are tightly butted.

To prevent flanking, a 6mm layer of WIL-MAT 60 must be turned up at the wall edges to a height of 5mm above the WIL-MAT RSD-T&G flooring level.

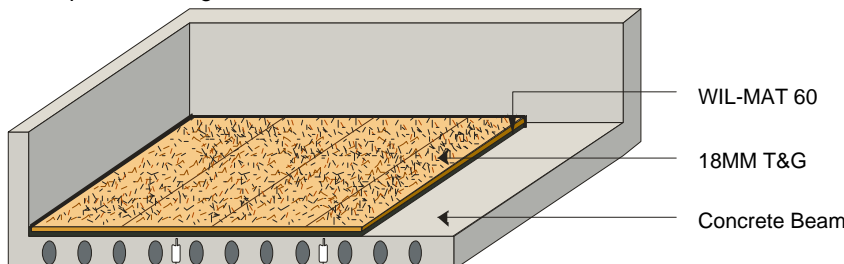

Wilhams Insulation Group

117 Bohemia Road, St Leonards-On-Sea, East Sussex TN37 6RL United Kingdom

Export Sales:- Tel: +44 (0) 1424 717171 Fax: +44 (0) 1424 20100 Email: sales@wilhams-insulation.co.uk

© Copyright 2005 Wilhams Insulation Limited.